



It's a Lifestyle

# Select Your Van

2012 FORD  
Ford Eff 8/1/11

# Pricing Your Sportsmobile

■ STANDARD PLANS →  
■ DESIGN YOUR OWN ■ OPTIONS  
Sportsmobile EFF 4/4/12

**"RB" (Regular Body) E-150 GVWR 8,600**  
ENG. - 5.4L - 330, V8 Triton • 4 Speed Trans  
STD. EQUIP. & OPTIONS- See list below

FORD DEALER LIST PRICE 32,080  
DISCOUNT (1,248)  
 TOTAL \$30,832

**"RB" (Regular Body) E-250, GVWR 9,000**  
ENG. - 5.4L - 330, V8 Triton • 4 Speed Trans  
STD. EQUIP. & OPTIONS. - See list below

FORD DEALER LIST PRICE 32,605  
DISCOUNT (1,300)  
 TOTAL \$31,305

**"RB" (Regular Body) E-350, GVWR 9,500** Eff. 4/4/12  
ENG. - 5.4L - 330, V8 Triton • 4 Speed Trans  
STD. EQUIP. & OPTIONS. - See list below

FORD DEALER LIST PRICE 33,510  
DISCOUNT (1,266)  
 TOTAL \$32,244

GAS ENG 6.8L - 415, V10 Triton; 5 Speed. Add  984  
DIESEL ENGINE No longer Available

All options, colors and specifications same as 2011.

**"EB" (Extended Body) E-250, GVWR 9,000**  
ENG. - 5.4L - 330, V8 Triton • 4 Speed Trans  
STD. EQUIP. & OPTIONS. - See list below

FORD DEALER LIST PRICE 33,280  
DISCOUNT (1,368)  
 TOTAL \$31,912

**"EB" (Extended Body) E-350, GVWR 9,500**  
ENG. - 5.4L - 330, V8 Triton • 4 Speed Trans  
STD. EQUIP. & OPTIONS - See list below

FORD DEALER LIST PRICE 34,495  
DISCOUNT (1,365)  
 TOTAL \$33,130

GAS ENG 6.8L - 415, V10 Triton; 5 Speed. Add  984  
DIESEL ENGINE No longer Available

ENGINES	HP (SAE NET)	TORQUE (LB. FT.)	MAX. TRAILER CAPACITY (LBS.)
5.4L V8	255	350	6,000
6.8L V10	305	420	10,000

AXLE RATIOS	STD	OPT	OPT W/LIM SLIP
5.4L E-150	3.73	4.10	3.73 or 4.10
5.4L E-250	3.73	—	3.73
5.4L E-350	3.73	4.10	3.73 or 4.10
6.8L E-350	3.73	4.10	3.73 or *4.10

\* For Sportsmobile's 4WD. You must order the 4.10 w/ limited slip.

- STD. EQUIP. INCLUDED ALL VANS**
- |  |                              |
|--|------------------------------|
| ADVANCE TRAC ROLL CONTROL (Now Standard) | WINDSHIELD WIPERS - Interval |
| AIR COND. In dash                        | FUEL TANK - 33G              |
| AIR BAGS - Driver & Passenger            | LIGHT & CONVENIENCE GROUP    |
| POWER MIRRORS                            | COURTESY LIGHT SWITCHES      |
| CONSOLE ENGINE COVER                     | HEADLIGHTS - ON ALERT        |
| BRAKES - Anti-lock. 4                    | ILLUMINATED ENTRY            |
| TIRE PRESS. MONITORING SYS               | DUAL ELECTRIC HORNS          |
| ALTERNATOR - 120 Amp.                    | FRONT STABILIZER BAR         |
|  | SHOCKS - HD. Front & Rear    |
- FORD OPTIONS ALSO INCLUDED**
- |                            |                                   |
|----------------------------|-----------------------------------|
| POWER DOOR LOCKS           | REMOTE KEYLESS ENTRY- Panic Alarm |
| POWER WINDOWS - Cab        | RADIO • PREMIUM w/Audio Jack      |
| BUMPERS - Chrome           | TRAILER WIRING HARNESS            |
| SPEED CONTROL / TILT WHEEL | UPFITTER SWITCHES - In Dash       |

**ADDITIONAL OPTIONS? Dealer Invoice Cost**

AXLE 4:10 - For E-350 5.4L	_____	38
For more towing capacity		
LIMITED SLIP AXLE - Reg. w/4x4	_____	224
(1) TRAILER TOW PKG. - E-150 & E-250	_____	328
(1) TRAILER TOW PKG. - E-350	_____	237
ALTERNATOR, HD 155A	_____	66
ALTERNATOR, HD 225A - Avail only V-10	_____	216
HEATER, ENGINE BLOCK	_____	62
GLASS, SWING OUT - Van's right side door	_____	154
AUXILIARY FUEL PORT-Need for generator	_____	21
POWER DRIVER'S SEAT - Will not swivel	_____	324
CAMERA, BACKUP	_____	390
REVERSE SENSING - Must Includ Camera	_____	232
(3) P REMIUM COMBO AUDIO/NAVIGATION SYSTEM	_____	1,909
SATELLITE RADIO, - Must have (3) above	_____	162
(4) SYNC	_____	394
MESSAGE CENTER	_____	158
ALUMINUM WHEELS	_____	257
SECURE LOCK - Passive alarm system	_____	62
(C) ADDITIONAL VAN COST COLOR?	_____	112

TOTAL YOUR ORDER \$ \_\_\_\_\_

**WHEELS 16"**

**TIRES**  
E - 150: LT 225 / 75R X 16E ALL SEASON  
E - 250: LT 245 / 75R X 16E ALL SEASON  
E - 350: LT 245 / 75R X 16E ALL SEASON

**SELECT VAN COLOR**

INTERIOR DASH & MOLDING  
CHARCOAL BROWN

• OXFORD WHITE - C

BLACK - C

VERMILLION RED

(C) FOLLOWING COLORS COST ADDITIONAL \$112

• INGOT SILVER - C - M (Add Cost)

DK BLUE PEARL

PUEBLO GOLD

STEEL BLUE

• MOST POPULAR C - CLEAR COAT M - METALLIC PAINT

IF YOU WOULD LIKE FOR SPORTSMOBILE TO ORDER A VAN FOR YOU, simply check the items you want. Mail a copy to Sportsmobile with deposit check.

FORD DIMENSIONS PLUS HEIGHTS with different tops - please see "Standard Floor Plans" brochure.

Sportsmobile cannot be responsible for price and specification changes made by Ford.

- (1) Includes hitch & 7-way hookup  
(3) Includes: 6 Disc in Dash CD Changer, audio Jack, Satellite Radio Compacity w/6 Mo. Subscription. In Dash Video Back Up Camera Display, HD Radio  
(4) Easy-to-use in-car connectivity system that allows you to operate most popular MP3 players, Bluetooth-enabled phones and USB drives with simple voice commands, Turn-by-Turn Directions, 911 Assisist, Vehicle Health Report, My Favorites, Real-time Traffic, Business Search

FORD DROP SHIP CODES • SPORTSMOBILE NORTH INC — 88MX98  
• SPORTSMOBILE TEXAS INC — 88RZ64 • SPORTSMOBILE WEST INC — 88WT89

FORD REBATE - IF YOUR FORD VAN QUALIFIES FOR A CUSTOMER REBATE, YOU WILL RECEIVE CREDIT

**Sportsmobile North Inc**  
**Sportsmobile West Inc**  
**Sportsmobile Texas Inc**

ORDERING DEALER \_\_\_\_\_  
ATTENTION \_\_\_\_\_  
REMARKS \_\_\_\_\_

NAME \_\_\_\_\_  
ADDRESS \_\_\_\_\_ CITY \_\_\_\_\_  
STATE \_\_\_\_\_ ZIP \_\_\_\_\_ PHONE: DAY ( ) \_\_\_\_\_  
 \$1,000 Deposit Attached  \$2,000 for 4x4 • (Deposits non-refundable)

THIS ORDER ACCEPTED BY CUSTOMER:  
SIGNED \_\_\_\_\_ DATE \_\_\_\_/\_\_\_\_/\_\_\_\_  
SPORTSMOBILE REP \_\_\_\_\_ APPROVED DATE \_\_\_\_/\_\_\_\_/\_\_\_\_



It's a Lifestyle

# Select Your Van

2011  CHEVY  
Chevy Eff 2/10/10B

# Pricing Your Sportsmobile

**"RB" (Regular Body) 2500, GVWR 8,600**

ENG. - 6.0L - 364, V8 VORTEC 6000-TRANS HD 6 SPEED  
STD. EQUIP. & OPTIONS INCLD- See list below

CHEVY/GM DEALER LIST PRICE 30,230  
DISCOUNT (926)  
TOTAL **\$29,304**

**"RB" (Regular Body) 3500, GVWR 9,600**

ENG. - 6.0L - 364, V8 VORTEC 6000-TRANS HD 6 SPEED  
STD. EQUIP. & OPTIONS INCLD- See list below

DEALER LIST PRICE 33,550  
DISCOUNT (1,092)  
TOTAL **\$32,458**

**"EB" (Extended Body) B3500, GVW 9,600**

ENG. - 6.0L - 364, V8 VORTEC 6000-TRANS HD 6 SPEED  
STD. EQUIP. & OPTIONS INCLD- See list below

DEALER LIST PRICE 34,435  
DISCOUNT (1,137)  
TOTAL **\$33,298**

**STD. EQUIP. INCLD. ALL ABOVE VANS**

AIR COND. In dash	RADIO - AM/FM-CD
AIR BAGS - Driver/Passenger	FUEL TANK - 31G
TRANS. 4 SPEED AUTO	HEAVY DUTY SUSPENSION
BRAKES - Rear/Front, Anti-lock	DUAL NOTE ELECTRIC HORN
BRAKE/TRAN SHIFT INTERLOCK	CD PLAYER

**VAN OPTIONS ALSO INCLUDED ALL ABOVE VANS**

TILT WHEEL & CRUISE CONTROL	COMPOSITE LIGHTS
POWER - WINDOW & DOOR LOCKS	WHEEL TRIM - Rally
POWER MIRRORS - Fold away	DAYTIME RUNNING LIGHTS
WINDSHIELD WIPERS - Interm.	KEYLESS ENTRY
ONSTAR SAFE & SOUND SERVICE, 1 year standard. For additional time see your Chevy Dealer.	GLOVE BOX LOCK
ALTERNATOR - 145A	OIL TRANS COOLER
BATTERY-800 Amp	Internal cooler is standard
WINDOWS, FIXED - Rear/Side Doors	
COMPASS=	
EXTERNAL TEMPERATURE	

**SELECT VAN COLOR**

	COST	INTERIOR DASH & MOLDINGS	
		GREY	NEUTRAL
SUMMIT WHITE	N/C	<input type="checkbox"/>	<input type="checkbox"/>
VICTORY RED	N/C	<input type="checkbox"/>	<input type="checkbox"/>
BLACK (M)	N/C	<input type="checkbox"/>	<input type="checkbox"/>
SANDSTONE (M)	132	<input type="checkbox"/>	<input type="checkbox"/>
DARK GREEN (M)	132	<input type="checkbox"/>	<input type="checkbox"/>
GREYSTONE (M)	132	<input type="checkbox"/>	<input type="checkbox"/>
DARK BLUE (M)	132	<input type="checkbox"/>	<input type="checkbox"/>
SHEER SILVER (M)	132	<input type="checkbox"/>	<input type="checkbox"/>

(M) - METALLIC PAINT

**ENGINE**

	HP (SAE NET)	TORQUE (LB. FT.)	MAX. TRAILER CAPACITY (LBS.)
6.0L V8	323	373	10,000
6.6L V8	260	525	10,000

**AXLE RATIOS** -3.42 STD.  
-3.42 LIMITED SLIP  
-3.73 Diesel

**WHEELS - 16"**

**TIRES** - LT245 / 75R16E, All season, 10 Ply

**ADDITIONAL OPTIONS? Dealer Invoice Cost**

(1) DIESEL ENGINE, GVWR 9,900. TOW 9,700LBS	10,378
DIESEL ENGINE PRE HEATER	770
HIGH IDLE, GAS/DIESEL	176
REMOTE START - Gas & Diesel	168
ENGINE BLOCK HEATER - Std. w/Diesel	66
AUX. FUEL PICKUP - Gas Eng.	108
LOCKING DIFFERENTIAL (Limited Slip)	286
TRAILERING EQUIP - HD Platform Hitch. Wire harness	233
<b>AIR BAG, HEAD/SIDE (N/A w/ Penthouse Top)</b>	
REAR WINDOW DEFROST	138
VENTED WINDOWS - Side Doors	160
POWER SEAT BASE - Driver	242
<b>STEERING WHEEL AUDIO CONTROL</b>	
MP3/6 DISC - in dash, controls on steering wheel	620
MP3/SINGLE CD, controls on steering wheel	444
ONSTAR, DIRECTIONS & CONNECTIONS PLAN, 6 Months	172
Add. time see your Chevy Dealer	
AM/FM, CD, MP3 UPGRADE - For Bluetooth	622
BLUETOOTH	44
<b>VAN COLOR</b> - Add cost, if any	132

Plus TT&L Your State TOTAL \$ \_\_\_\_\_

If you would like for Sportsmobile to order a van for you, simply check the items you want. Mail a copy to Sportsmobile with deposit check.

Chevy/GM dimensions plus heights with different tops - please see "Standard Floor Plans" brochure.

Sportsmobile cannot be responsible for price and specification changes made by Chevrolet/GM.

(1) Duramax Turbo Diesel, 6.6L- V8 260 HP @ 3100 rpm, 525 ft-lbs. torque. Transmission 5-Speed HDS, electronically controlled with overdrive. Fuel efficiency 17-18mpg. Very quiet running.

**CHEVY / GM REBATE - IF YOUR CHEVY GM VAN QUALIFIES FOR A CUSTOMER REBATE, YOU WILL RECEIVE CREDIT**

**Sportsmobile North Inc**  
**Sportsmobile West Inc**  
**Sportsmobile Texas Inc**

ORDERING DEALER \_\_\_\_\_  
ATTENTION \_\_\_\_\_  
REMARKS \_\_\_\_\_  
\_\_\_\_\_  
\_\_\_\_\_

NAME \_\_\_\_\_  
ADDRESS \_\_\_\_\_ CITY \_\_\_\_\_  
STATE \_\_\_\_\_ ZIP \_\_\_\_\_ PHONE: DAY ( ) \_\_\_\_\_  
 \$1,000 Deposit Attached  \$2,000 for 4x4 • (Deposits non-refundable)  
THIS ORDER ACCEPTED BY CUSTOMER:  
SIGNED \_\_\_\_\_ DATE \_\_\_\_/\_\_\_\_/\_\_\_\_  
SPORTSMOBILE REP \_\_\_\_\_ APPROVED DATE \_\_\_\_/\_\_\_\_/\_\_\_\_

## Pricing A "Standard" Floor Plan

Furnishings can be deleted and changed as you desire. See next page for prices.

Systems can also be deleted for credit, such as the propane system and stove. See options, back page, for deletions.

### NOW STANDARD

**INVERTER** (12 to 110V) Magnum 2000W, 100A, True Sine, Aux. Batt Charger. In place of prior Converter (110 to 12V), 65A.

**"GREEN" INSULATION** In place of fiberglass (same R13 value) • Reduces carbon emissions. No formaldehyde or VOCs. Will not absorb moisture. Superior Acoustics. 100% Recyclable.

### SELECT A STANDARD PLAN

**Each Standard Floor Plan includes: Items 1 and 2 listed below**

## 1 STANDARD EQUIPMENT PACKAGE

### INTERIOR

WALL PANELS Green insulation  
 FLOOR Marine Vinyl or Loop Carpet  
 SHADES In place Curtains side/rear doors  
 CURTAINS Cab  
 CORNICES Upholstery trim, sides and rear  
 OVERHEAD CAB MODULE (N/A Chevy)  
 DOOR PANELS Sides and rear  
 VAN DOOR COMPARTMENTS  
 TABLE Any size  
 FIRE EXTINGUISHER  
 FLOOR MATS (3)

### 110V SYSTEM

110V ELECTRICAL PANEL 30 Amp System  
 110V EXTERIOR INLET W/25' cord  
 GFI Ground fault protection  
 ELECTRICAL CORD ADAPTERS  
 110V WALL OUTLETS  
 INVERTER (110 to 12V) 2000W, 100A, Aux. Batt. Chg. True Sine

### 12V SYSTEM

BATTERY SEPARATOR Prevents van battery drain.  
 12V ELECTRICAL PANEL  
 12V OUTLET  
 12V POWER Cut-off Switch  
 VOLT METER  
 LIGHTS Throughout interior & exterior light  
 AUXILIARY BATTERIES AGM BATTS  
 OR One large AGM battery  
 DETECTORS Carbon monoxide, Smoke detector

### GALLEY

REFRIGERATOR "3E" Electric, Norcold 2.7 CF  
 FRESH WATER SYSTEM  
 SINK PULL OUT FAUCET  
 WATER PUMP 12V Demand System  
 WASTE WATER Sink (gray) water hold tank  
 CITY WATER HOOKUP  
 STOVE Flush Mount (May delete)

### PROPANE SYSTEM (May delete for credit)

For stove and furnace (O), hot water heater (O), gas refrigerator (O), 8G tank with Danhard A/C (O) 5.5G, tank. Propane detector.

## 2 FURNISHINGS & WINDOWS

INCLUDED AS SHOWN ON EACH PLAN

(O) Additional cost options  
 • Swivel for Captain's Seats (O)

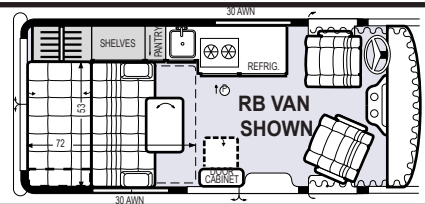

<b>RB</b> Regular Body	10 \$24,647	13 \$25,392	16 \$23,850	21 \$24,374	33 \$25,410	37 \$24,790	41 \$25,260	54 \$25,974	✓ Check the floor plan of your choice.
	11 22,945	14 26,517	17 25,322	30 25,802	34 24,087	38 23,779	42 23,851	55 25,185	
	12 25,231	15 26,003	20 25,416	31 25,359	36 24,800	40 24,763	50 26,056		
<b>EB</b> Extended Body	10 \$26,813	14 \$26,812	21 \$27,400	27 \$24,430	40 \$28,539	44 \$28,929	49 \$26,827	70 \$26,131	83 \$23,804
	11 26,695	15 25,902	22 28,809	28 25,399	41 \$27,588	45 26,535	50 26,341	80 26,304	200 24,140
	12 25,163	18 28,027	24 25,876	29 26,731	42 27,788	47 27,019	60 28,198	81 26,251	201 24,687
	13 27,605	19 27,944	25 26,431	31 25,431	43 25,802	48 25,823	61 27,672	82 25,838	

I WANT TO "DELETE" THESE ITEMS: \_\_\_\_\_ (- \_\_\_\_\_)

"ADD" THESE ITEMS: \_\_\_\_\_ (+ \_\_\_\_\_)

<b>SELECT A TOP</b> <b>PENTHOUSE EXPANDABLE TOPS</b> PENTHOUSE "RB" Vans _____ 5,719 "EB" Vans _____ 6,160 PENTHOUSE "G" GARAGABLE for Ford RB _____ 5,591 83" overall height w/conversion (8600 GVWR) ZIPPERED SCREENS Front and front 2 sides, add _____ 99 BED Removable, sleep 2 (can add later) _____ 425 CUSTOM PAINT To paint color other than std white _____ 739 POWER TOP, 12V _____ 1,234	<b>FIXED TOPS</b> Includes Custom Inside Finish, Front & Rear Compartments, L&R side shelves. Two Lights. Heat-gain reflective bubble foil insulation. Automotive paint to match your van.	<b>OPTIONS FOR "FULL HEIGHT TOPS" WINDOWS, SIDES</b> W/screens. Ea. _____ 353 CURTAINS For above windows. Ea. _____ 60 SHADES W/trim panel. Ea. _____ 126 UPPER BED _____ 472	
	<b>LOW PROFILE TOPS FORD CHEVY</b> CONTEMPO TOP RB Vans   _____ 6,041 EB Vans   _____ 6,384	<b>OPTIONS FOR "ALL FIXED TOPS" SIDE COMPARTMENT</b> L or R side, 2' long _____ 155 Each additional foot _____ 47 L or R side, full length _____ 378 VANITY CABINET W/ lights, mirror _____ 327	<b>VAN TOP TOTAL</b> \$ _____
	<b>FULL HEIGHT TOPS</b> VOYAGER TOP RB Vans   _____ 5,983 EB Vans   _____ 6,064 Voyager top only - If select "white" color. Credit _____ (-752) CRUISER II EB Vans  _____ 6,579		
	<b>NOTE</b> Please use this form for pricing rather than making a separate listing. Make a copy for your files. Website has most current pricing and supercedes printed material.	<b>STANDARD PLAN TOTAL (above)</b> \$ _____	
		<b>TOP TOTAL (above)</b> \$ _____	

	<b>OPTIONS (see separate page)</b> \$ _____	
	<b>4 X 4 (see separate page)</b> \$ _____	
	<b>SPORTSMOBILE TOTAL</b> \$ _____	
	<b>VAN COST (see "Select Your Van" sheet)</b> \$ _____	
CUSTOMER _____ / _____ / _____	Plus TT & L Your State <b>GROSS TOTAL</b> \$ _____	

## Pricing A "Design Your Own" Floor Plan



If a standard plan or modified one doesn't meet your requirements, there are two ways you can Design Your Own:

**Cutouts.** Cut out the furnishings of your choice and paste or tape them to your van plan.

**Online.** This is now the most popular way to develop your preliminary custom design.

For more information see our website Design Your Own (DYO) - Info button.

Our price list for furnishings is to the right. The cost for your customized plan will be about the same as if it were a "Standard Floor Plan."

Questions? Please contact us.

Installation is included in all prices.

Prices are based on installation installed at the time of the conversion of your van. If installed as separate parts or options the cost may be more for the additional labor cost.

### DESIGN YOUR OWN PLAN COST

### To Price Your SPORTSMOBILE Start With:

1 STANDARD EQUIPMENT PACKAGE

2 THEN ADD FURNISHINGS BELOW

NOTE: IF YOU ARE MODIFYING A "STANDARD FLOOR PLAN," USE THE FOLLOWING PRICES FOR ADDITIONS AND DELETIONS.

#### SEATS / BEDS

CAPTAINS'S SEATS - 3 & 4. Ea \_\_\_\_\_ 1,723

All seats include seat belts and pillows

DINETTE "W" Wall panels recessed (2) \_\_\_\_\_ 1,833

Same as above-except only about 30" wide \_\_\_\_\_ 1,363

DINETTE "L" \_\_\_\_\_ 2,177

BACK CUSHION TOP BOLSTER, Ea \_\_\_\_\_ 96

GAUCHO With wall panel recessed \_\_\_\_\_ 1,581

BED EXTENSION CUSHION Makes bed about 9" longer \_\_\_\_\_ 88

COUCH Faces forward, full width \_\_\_\_\_ 1,858

OTTOMAN Set of two \_\_\_\_\_ 661

SOFA Faces forward, 3/4 width \_\_\_\_\_ 1,489

SOFA MATTRESS \_\_\_\_\_ 408

STORAGE COMPT. "M" W/Closet (See RB\*50) \_\_\_\_\_ 1,225

"L" W/Top Cushion (SeeRB\*55) \_\_\_\_\_ 859

PLATFORM BED \_\_\_\_\_ 1,203

#### CABINETS

GALLEY B For Sink, Stove, 3E (2.7 CF) Refrig will fit \_\_\_\_\_ 963

E For Sink, Stove, Microwave will fit \_\_\_\_\_ 1,063

F For Sink, Stove, \_\_\_\_\_ 889

C For Stove, will fit \_\_\_\_\_ 632

D For Sink, will fit \_\_\_\_\_ 568

G For Sink, Stove, 3E Refrigerator \_\_\_\_\_ 1,313

See RB-50

Sink, stove, Refrig cost incl. in Std Equip Pkg

CABINET H For 3E (2.7 CF) Refrigerator will fit \_\_\_\_\_ 719

HA " \_\_\_\_\_ 585

G For E (3.6 CF) Refrigerator will fit \_\_\_\_\_ 600

GA " \_\_\_\_\_ 630

GB " \_\_\_\_\_ 507

GC " \_\_\_\_\_ 615

CLOSET B Porta Potti will fit \_\_\_\_\_ 555

C With 2 lower drawers \_\_\_\_\_ 627

D With shelves, Porta Potti will fit \_\_\_\_\_ 577

FIXED TOPS to make above cabinets & closets ceiling height. Add per cabinet \_\_\_\_\_ 99

STORAGE CABS C 2 Drawers, Porta Potti will fit \_\_\_\_\_ 645

D 4 Drawers \_\_\_\_\_ 737

E 2 Adjustable shelves \_\_\_\_\_ 524

J W/ 2 shelves \_\_\_\_\_ 690

K W/ 2 shelves, 2 drawers \_\_\_\_\_ 749

L See Std Plan RB-55 \_\_\_\_\_ 966

M " RB-50 \_\_\_\_\_ 1,225

PANTRY, REMOVABLE 28" high \_\_\_\_\_ 454

PANTRY, SLIDE-OUT 28" counter top high \_\_\_\_\_ 474

49" ceiling high \_\_\_\_\_ 623

SIDE COMPARTMENT Install on "side" of other cabinet \_\_\_\_\_ 392

GALLEY UPPER SHELF W/ 2 halogen lights \_\_\_\_\_ 255

VANITY CABINET W/ decorative lights, over galley \_\_\_\_\_ 313

END CABINET \_\_\_\_\_ 348

SIDE DOOR GALLEY "Swing Away" \_\_\_\_\_ 672

DESK Owner design \_\_\_\_\_ TBD

TRUNK CABINET \_\_\_\_\_ 719

PARTITION Full van width W/door \_\_\_\_\_ 547

**Baths** Baths include: Bath Compt., Shower Curtain, Light, Towel Rod, GW Tank, #10 Marine Toilet included & a BW Holding Tank, Termination Valve, 3rd Drain Hose and Carrier. For more info see Web Site Options - then Baths.

1. SHOWER w/COMPARTMENT \_\_\_\_\_ 1,787

2. SHOWER w/SINK CAB Med. Cab \_\_\_\_\_ 2,635

3. COMBO BATH & MARINE TOILET, Med & Cabinet A \_\_\_\_\_ 3,400

4. COMBO BATH & MARINE TOILET & SINK CAB \_\_\_\_\_ 3,952

Med & Cabinet A

SEPARATE SMALL SINK available for Baths 1 & 2 \_\_\_\_\_ 281

SINK CAB Included w/ Baths 2 & 4. Avail. Separately \_\_\_\_\_ 552

BATH CABINET Tall w/Shelves \_\_\_\_\_ 301

#### WINDOWS (See "Cut Sheets" for drawings)

Windows are included with Standard Floor Plans.

All include • shades • screens • in-side trim panels • Tinted

All WINDOWS ARE AVAIL. W/O shades & inside trim

SLIDERS ① 18"W X 15"H \_\_\_\_\_ 400

② 30"W " \_\_\_\_\_ 470

③ 42"W " \_\_\_\_\_ 564

④ 60"W " \_\_\_\_\_ 616

AWNING ⑩ 30"W X 17"H \_\_\_\_\_ 746

BAY WINDOWS ⑪ 28"W X 30"H \_\_\_\_\_ 737

⑫ 34"W X 24"H \_\_\_\_\_ 770

⑬ 40"W X 28"H \_\_\_\_\_ 778

WINDOW TINT All windows have light tint.

A darker tint can be added \_\_\_\_\_ TBD

SPECIAL CABINETS \_\_\_\_\_ TBD

SOLID SURFACE COUNTERTOP

for special cabinets,etc. Add per sf \_\_\_\_\_ 47

2 FURNISHINGS TOTAL \$ \_\_\_\_\_

NOTE Please use this form for pricing rather than making a separate listing. Make a copy for your files	1 STD. EQUIP. PKG. "RB" VAN	\$ 19,176
Website has most current pricing and supercedes printed material.	"EB" VAN	\$ 19,489
	2 FURNISHINGS (as selected above)	\$
	VAN TOP TOTAL (see Std. Plans page)	\$
	OPTIONS (see separate page)	\$
	4x4 (see separate page)	\$
	SPORTSMOBILE TOTAL	\$
	VAN COST (see "Select Your Van" sheet)	\$
CUSTOMER _____ / _____ / _____	Plus TT&L Your State GROSS TOTAL	\$

# Sportsmobile Options - Ford & Chevy/GM

For more option info, see our web site. • All prices include installation

Eff. 4/4/12B

Click orange to see web page "•" indicates item on web page Use your internet browser's "Back Button" to return to this page

**CALIFORNIA** Charge for additional CA state cost & misc \_\_\_\_\_ 350

## "Exchange" Items

CHERRY WOOD GRAIN in exchange for Dove Grey \_\_\_\_\_ 287

MARINE DECK VINYL  LOOP PILE CARPET  \_\_\_\_\_ std

LONDECK RUBBERIZED Additional cost "RB" van \_\_\_\_\_ 287

"EB" \_\_\_\_\_ 395

LONCOIN RUBBERIZED Additional cost "RB" van \_\_\_\_\_ 473

"EB" \_\_\_\_\_ 617

FRESH WATER TANK 10G \_\_\_\_\_ std

LARGER TANK 17G \_\_\_\_\_, 20G \_\_\_\_\_ 51

REF. 3E Electric - Norcold 2.7 CF - Std Equip. \_\_\_\_\_ std

4E " " 3.6 CF - Exchg for 3E \_\_\_\_\_ 538

RECOVER FORD "CAB SEATS", 1 pr \_\_\_\_\_

FABRIC  or VINYL  Incls disassembly & assy, 1 pr. \_\_\_\_\_ 658

LEATHER or ULTRALEATHER (Vinyl trim), 1 pr. \_\_\_\_\_ 890

## \* UPHOLSTER SEATS BELOW IN:

LEATHER  or ULTRALEATHER

CAPTAIN'S SEATS 3rd or 4th Ea. \_\_\_\_\_ 275

GAUCHO or COUCH \_\_\_\_\_ 516

SOFA \_\_\_\_\_ 449

DINETTE "L" 1 pr \_\_\_\_\_ 918

TOP BOLSTER, For Dinette, Ea. \_\_\_\_\_ 77

DINETTE "W" 1 pr \_\_\_\_\_ 687

OTTOMAN, Set of two, For use w/couch. \_\_\_\_\_ 199

\* In place of Fabric or Vinyl (W/Vinyl trim)

## "Delete" Items

PROPANE STOVE Credit \_\_\_\_\_ (-492)

PROPANE TANK SYSTEM Credit \_\_\_\_\_ (-1,154)

Several Std Plans have Propane deleted. If you want Propane add it back in \_\_\_\_\_ 1,154

## A/C / Ventilation / Heat

• ATTIC FAN 3 Speed, Hi volume. Low amperage. \_\_\_\_\_ 243

DELUXE W/thermostat. Rain sensor. \_\_\_\_\_ 319

• A/C ROOF MOUNT 13,500 BTU, 110V. \_\_\_\_\_ 1,434

High efficiency. White shroud cover.

SHROUD PAINTED to match van, Add \_\_\_\_\_ 138

• A/C DANHARD 110V Inside mount. 12,000 BTU Will \_\_\_\_\_ 3,788

also run on 15A house service or portable Honda Generator

NOTE: Above A/Cs will run about 1 hr when Aux. Batts.

charged- longer when van engine is running with an inverter.

See Web Site for more info

WINDOW TINT, per window \_\_\_\_\_ 55

• WINDSHIELD & CAB DOORS SCREEN To help keep sun out. Daytime privacy \_\_\_\_\_ 152

• FURNACE PROPANE 19,000 BTU Blower fan 12 & 110V \_\_\_\_\_ 1,510

Electronic Ignition connects to propane tank.

• HEATER, PORTABLE 110V Ceramic. Buy Locally.

## BATHS Also see "Furnishings" page 3

• PORTA POTTI Manual fresh water flush. \_\_\_\_\_ 98

• PORTA POTTI CURVE new. Electric Flush. \_\_\_\_\_ 198

• HASSOCK COVER \_\_\_\_\_ 39

• MARINE TOILET Permanent mount over black water holding \_\_\_\_\_ 1,179

tank includes w/3" drain hose & outside storage compt.

IF MOUNT Holding Tank above floor w/shorter toilet, add \_\_\_\_\_ 128

MACERATOR TOILET W/built in Macerator which \_\_\_\_\_ 2,181

will pump into included black water tank. This permits the toilet

to be mounted most anywhere. A 1" hose is incld. to drain tank

MACERATOR WASTE PUMP "Portable" \_\_\_\_\_ 438

RECESS FLOOR SHOWER W/curtain & grey water tank \_\_\_\_\_ 806

PORTA SHOWER Shower wand connects to sink faucet \_\_\_\_\_ 367

EXTERIOR SHOWER Install van side, No curtain \_\_\_\_\_ 348

WATER HEATER, 110V Fast recovery. W/bypass valve \_\_\_\_\_ 606

PROPANE 6G. N/A "RB" W/bypass valve \_\_\_\_\_ 1,185

FLAT PLATE Heats water with engine \_\_\_\_\_ 1,171

running or with Engine Preheater.

## Electrical, 12 & 110V

BATTERY MONITOR available for Inverter. Monitors voltage and \_\_\_\_\_ 318

amperage in Aux. Batt System. Very helpful in determining state

of Aux. Batt. System

## Solar Panels

This technology, panel sizes, Amps and prices changes fast .

See our web site for more info.

• SOLAR PANELS Max Output 7A, Includes Blue Sky \_\_\_\_\_ 1,057

controller. State of the art. Increases charge current 30%

• ADDITIONAL SOLAR PANELS Ea. \_\_\_\_\_ 698

• PREWIRE for portable solar panels W/ Blue Sky Controller \_\_\_\_\_ 393

MICROWAVE Defrost/cook. W/110V Outlet \_\_\_\_\_ 191

MICROWAVE / CONVECTION W/110V Outlet( 21" W) \_\_\_\_\_ 491

## Generators

• GENERATOR 2.8K GASOLINE Onan Microlite. \_\_\_\_\_ 3,769

Remote start/stop swich. Automatic change over.

Hour meter. Uses fuel from van's fuel tank.

• GENERATOR 4K GASOLINE \_\_\_\_\_ 4,399

Same as above except larger

• GENERATOR 2.5K PROPANE Onan Microlite. \_\_\_\_\_ 3,819

Remote start/stop swich. Automatic change over.

Hour meter. The propane tank will run the A/C

about 24 hours "continuously".

NOTE: All generators must include a receiver hitch to help

protect generator on steep grades

• PORTABLE GEN "COMPARTMENT" to stow gen in van. \_\_\_\_\_ 528

Sealed and vented/ See web site.

## Electronic / Entertainment

TV ANTENNA, STEALTH. Signal booster, 12V outlet \_\_\_\_\_ 280

cable hookup, wall switch control

• TV ANTENNA Wingard directional \_\_\_\_\_ 321

crank up w/cable hook-up. HD Compatible

• SATELLITE, STATIONARY, Road Trip \_\_\_\_\_ 1,754

IN MOTION, KVH A7 (W/New GPS tracking) \_\_\_\_\_ 4,383

TV 15" FLAT SCREEN HD, LCD, DVD, CD & MP3 \_\_\_\_\_ 596

Swing out arm.

• TV 22" FLAT SCREEN HD, LCD, DVD, CD & MP3. \_\_\_\_\_ 680

Swing out arm

• TV STORAGE CABINET Mounts under TV, Solid Surface \_\_\_\_\_ 195

PREMIUM SOUND SYSTEM \_\_\_\_\_ TBD

Premium Sound Systems, head installations, etc.

installed by outside sound companies.

## Interior Options

CAPTAIN'S SEAT, SWIVEL, Driver  Pass.  Ea. \_\_\_\_\_ 336

LUMBAR, Driver  Pass.  Ea. \_\_\_\_\_ 127

HEATED, Driver  Pass.  Ea. \_\_\_\_\_ 218

CARPET OVERLAY Front Carpet in Cab Standard \_\_\_\_\_ 171

Full length \_\_\_\_\_ 196

STORAGE COMPT, FORD Under rear floor, inside access \_\_\_\_\_ 719

XL STORAGE COMPT, FORD Same as above, except \_\_\_\_\_ 1,157

specially fitted for max size, special coating in/out, 8 CF

PRIVACY CURTAIN to partition cab \_\_\_\_\_ 166

BIFOLD OR ACCORDION DOOR \_\_\_\_\_ 154

CAB SEATS CAPTAIN'S BED Tri-fold for storage \_\_\_\_\_ 249

TEMPERATURE PAGER Alerts customer of interior \_\_\_\_\_ 543

temp. change, 12/110 V, Portable, installed.

## Exterior Options

BACK-UP CAMERA w/color screen & night vision \_\_\_\_\_ 994

110V OUTLET, EXTERIOR Instl van side. GFI \_\_\_\_\_ 81

• RUNNING BOARDS, ALUM w/black rubber coating \_\_\_\_\_ 760

and courtesy lights front / rear Ford \_\_\_\_\_ 947

Chevy \_\_\_\_\_ 897

RUNNING BOARDS, FIBERGLASS Painted van color \_\_\_\_\_ 319

• FOG/DRIVING LIGHTS Hella 500, Pair \_\_\_\_\_ 1,158

• AWNING - 7' 6" X 10'. Alum. case, for RB & EB Vans \_\_\_\_\_ 346

• AWNING CASE PAINTED to match van color \_\_\_\_\_ 288

• TIRE CARRIER Installs on driver's rear door. \_\_\_\_\_ 720

Stock tires only.

TIRE CARRIER HD Installs in front of rear bumper. Swing- \_\_\_\_\_ 720

away. For standard or larger tires. Aluminum. Black

powder coating.

TIRE COVER Continental cover \_\_\_\_\_ 313

Vinyl \_\_\_\_\_ 65

RECEIVER HITCH - W/4 way harness \_\_\_\_\_ 489

• W/ 7 way harness \_\_\_\_\_ 629

• THULE ROOF RACK W/72" tracks (2), Towers (4) \_\_\_\_\_ 604

Crossbars 66" (2) Cp Rack

• THULE ROOF TRACKS Only (2), 72" long \_\_\_\_\_ 297

119" long \_\_\_\_\_ 416

THULE PARTS are available See www.thule.com

• LADDER for van rear door - Chrome \_\_\_\_\_ 221

Black, powder coated \_\_\_\_\_ 267

## 4-Wheel Drive and Options

A number of 4x4 Options are also available for 2 wheel drive vans. Please see

our web site - 4x4 Options Menu Button

Please see 4x4 price sheet

## OPTIONS TOTAL \$ \_\_\_\_\_

Sportsmobile continually strives to improve its products.

Therefore, all specifications, colors, designs and prices are

subject to change without notice or obligation.

Website has most current priced and supercedes printed material

Some options not available at all Sportsmobile

locations.

©2012 Sportsmobile